



2025-2026

**Consider
Festival Place for
your next event**

Set in the heart of Sherwood Park, in Broadmoor Lake Park, Festival Place is a unique location at which to host your next performance, event or meeting. With a 489-seat theatre, outdoor patio and multi-purpose spaces, there are many options to choose from.



Full facility

28,000 square feet

With a 489-seat theatre, outdoor patio, large multi-purpose space and rooms, the possibilities are endless.

Premium exhibition and conference space including an acoustically superb theatre and four breakout rooms of varying sizes. See Technical Stage Specs on page 8 for information specific to the Theatre.

For events

- \$259.61/hours
(minimum 5 hours, maximum 16 hours)
- Non-profit: \$146.00/hour
(minimum 5 hours, maximum 16 hours)

Base rate, additional fees may apply





Sherwood Park room

1,415 square feet

The Sherwood Park room is great for groups of 30 to 100 guests.

The room is carpeted with large windows overlooking Broadmoor Lake. The room is connected to the outdoor patio which is a perfect location for summer parties and meetings.



For meetings

- \$51.50/hour
- Non-profit: \$30.90/hour

For banquets

- Full day (9 a.m. - 2 a.m.): \$396.18
- Additional ceremony on patio, Peace Park or in the Sherwood Park Room: \$346.08

Base rate, additional fees may apply



Ardrossan room

1,506 square feet

The Ardrossan room is an ideal space for groups of 30 to 120 guests.

The room has parquet wood flooring and has private access from the outside.

For meetings

- \$51.50/hour
- Non-profit: \$30.90/hour

For banquets

- Full day (9 a.m. - 2 a.m.): \$396.18
- Additional ceremony on patio, Peace Park or in the Ardrossan Room: \$346.08

Base rate, additional fees may apply



Sherwood Park room, Ardrossan room and foyer combined

6,500 square feet

Opening up the walls in the front area can accommodate a party of up to 350 guests.

This allows a dance floor in the Ardrossan room and beverage service off the main bar in the Foyer.

For meetings

- \$164.80/hour
- Non-profit: \$98.88/hour

For banquets

- Full day (9 a.m. - 2 a.m.): \$1,151.54
- Additional ceremony on patio, Peace Park or in the Sherwood Park/Ardrossan room: \$346.08

Base rate, additional fees may apply

Sherwood Park room and Ardrossan room combined

2,938 square feet

These rooms together are fantastic for social gatherings up to 175 guests.

This allows for a dance floor and room to move.

For meetings

- \$103.00/hour
- Non-profit: \$61.80/hour

For banquets

- Full day (9 a.m. - 2 a.m.): \$721.58
- Additional ceremony on patio, Peace Park or in the Sherwood Park/Ardrossan Room: \$346.08

Base rate, additional fees may apply



Fultonvale and Josephburg studios

1,019 square feet

Perfect for smaller groups of up to 50 guests in theatre-style configuration or banquet rounds of eight.

Big windows with lots of light, tiled floor, and large floor length mirrors.

For meetings

- \$28.22/hour Non-profit: \$16.95/hour

For banquets

- Full day (9 a.m. - 2 a.m.): \$358.85
- Additional ceremony on patio, Peace Park or in the Sherwood Park/Ardrossan room: \$346.08

Base rate, additional fees may apply

Patio or Peace Park

Beautiful outdoor space to host your wedding ceremony, reception or add on to your indoor space.

For wedding ceremony

- 2 hours: \$521.80
- 2 hour with reception: \$346.08

For banquets

- Patio or Peace Park (until 11 p.m.): \$81.12/hour
Includes building access.
- Peace Park (until 11 p.m.): \$43.14/hour
No building access.

Base rate, additional fees may apply





Theatre and stage

34' wide x 36' deep

Our intimate 489 soft-seat theatre is the perfect venue to host your event, whether it be a concert, presentation, dance, drama or musical production. The theatre is equipped with an advanced lighting system, a wide range of audio equipment and a Petrof concert grand piano. There is accessible seating around the perimeter of the fixed theatre seats along with various seating options.

Commercial rentals

- Consecutive 5-hour performance block: \$1,125.21
- Additional hours: \$238.44/hour
- Includes 1 technician and 1 front of house

Non-profit rentals

- Consecutive 5-hour performance block: \$648.90
- Additional hours: \$143.17
- Includes 1 technician and 1 front of house

Base rate, additional fees may apply

A not for profit registration number will be requested at time of booking to qualify for these rates. The client is responsible for technician overtime after eight hours. The number of technicians required for your rental is at the discretion of the technician and will be an extra cost to the renter which will be identified to the client in advance. All rentals include 1 front of house. A second front of house is required if capacity exceeds 249 patrons and will be an extra cost to the rental.

Technical stage specs

Stage performance area

- The stage playing depth from:
 - front of stage to cyclorama is 37' 10"
 - front of the stage to main drape is 7'
 - from main curtain to cyclorama is 29' 6"
- Proscenium width is 40'
- Proscenium height is 24' 7"
- Standard trim is 34' wide. This leaves approximately 10' wing space each side.
- Crossover is accomplished using the hall directly behind the stage.

Orchestra pit

- The orchestra pit is 9' 10" deep and can fit 20 musicians. Conductor must use a 34" riser to see the stage. If you aren't familiar with Festival Place, the Pit is covered to accommodate seating. To cover or uncover the Pit takes 5 technicians 2 hours to complete at a cost to the client.

House

- 489 seat capacity with 120 of these in the balcony. On the main floor 92 chairs are portable on the flat area nearest the stage. Accessible seating is available along the perimeter of the theatre.

Stage

- The stage is sprung and covered with 1/4" tempered hardboard, smooth side up, painted black.

Masking and soft goods

- Main drape – Eggplant Cotton Velour
- 4 black cotton velour borders 10' X 54'
- 3 sets of black cotton velour legs 28' X 10'
- 1 white Muslin Cyclorama 28' X 50'
- 1 black sharktooth scrim 28' X 54'
- 2 Full stage black velour travelers (mid-stage and up stage) used as legs when open.

Fly system description

- Fly System is T-Track, single purchase. Fly rail is SR at deck level
- Handline is stage set X 3/4 inch Synthetic Rope all hardware is Atlas Silk
- 30 lines at 8" centres
- Total Flying height 54' 10"
- Pipes are 54' long



Rental information

- Complete set up of the event is included in the rates. The client is responsible for supplying, setting up and tearing down decorations at the end of the evening.
- Rentals are until 2 a.m.
- The DJ cannot play longer than 1 a.m.
- The bar is closed at 1 a.m.

How to book

Contact Brandy Morrison at 780-410-8567
brandy.morrison@strathcona.ca

Catering

All food and beverages are supplied by the in-house caterer The Hat at Festival Place. Contact Mike at 780-224-2765 to arrange catering as part of your room rental.

www.thehatcatering.com/at-festival-place

For the protection of our guests, The Hat Catering will be the sole supplier of all food and beverage services.

Deposit and cancellation policies:

- Please sign and return license form within 48 hours to confirm your booking. If not signed, the license will be null and void without further notice.
- An initial payment equal to 50 percent of the rental total is required at time of booking. Final amount payable is subject to change due to additional charges incurred during the event.
- If you cancel nine months or more before your booking date you will be refunded your initial payment.
- Cancellation between nine and six months will be refunded 50% of your initial payment.
- No refund with less than six months cancellation.



Please note: Fees may be subject to minor annual increases. We will adjust prices and forward you a revised license if applicable.

Floor plan

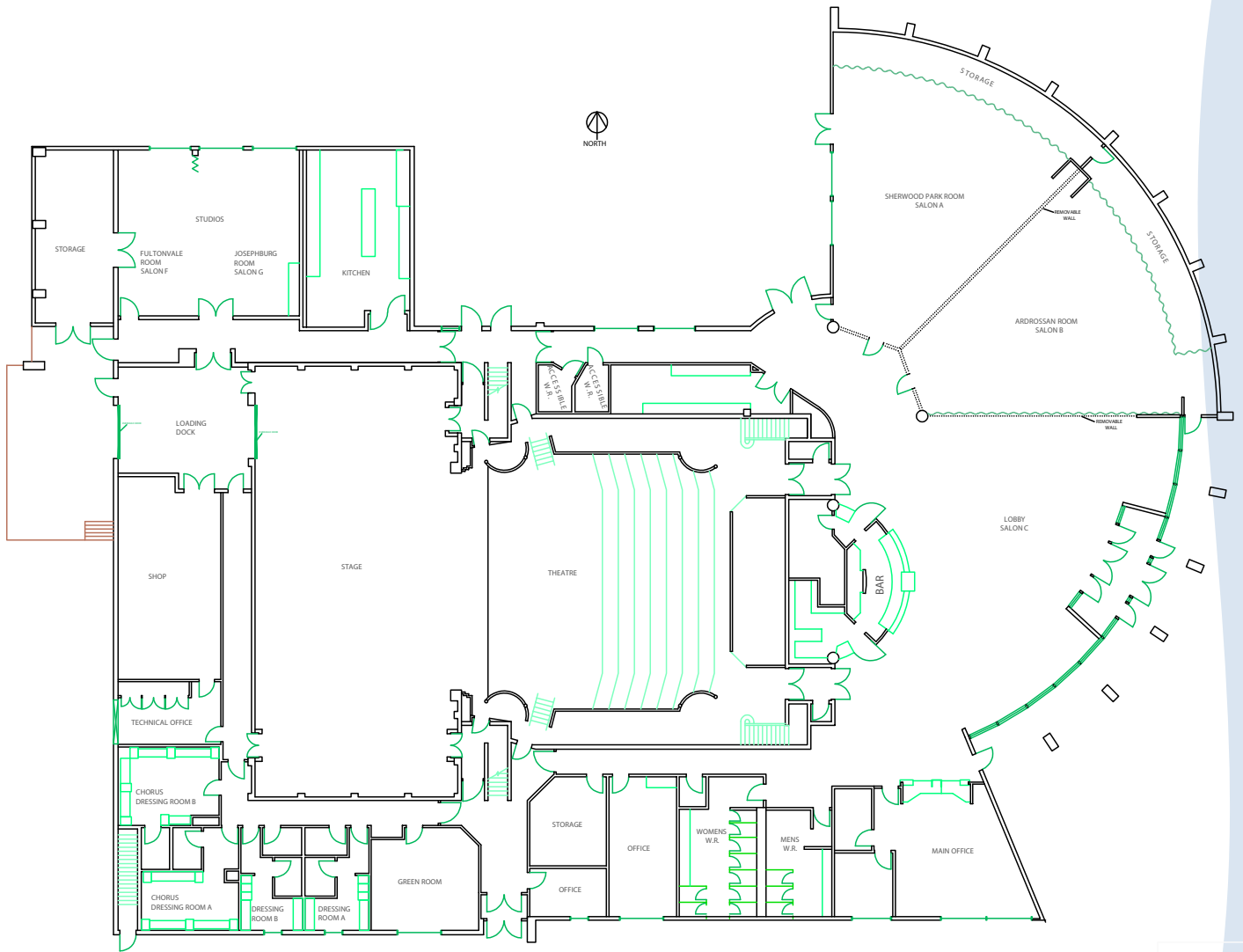



100 Festival Way
Sherwood Park, Alberta
T8A 5T2

Booking inquiries:

Brandy Morrison
780-410-8567
brandy.morrison@strathcona.ca

festivalplace.ca

